

HVA ER DIN PERFECT DUO?





T
TMAN
IS
HURLED
BY THE
REVOLVING
DOOR
TOWARD
A
MENACING
MOB...

...N THE FR...
RY NOTE...
VE THE M...

WELCOME TO GOTHAM CITY
OTHER
DOWN!
WORTH



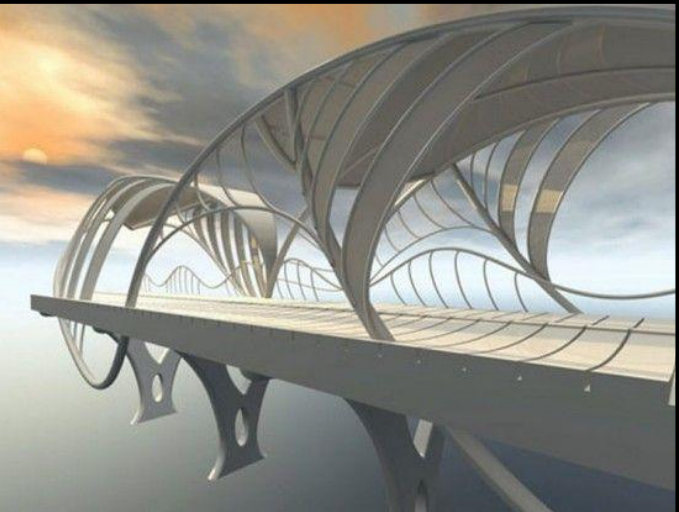

2019-05-27

gifak.net



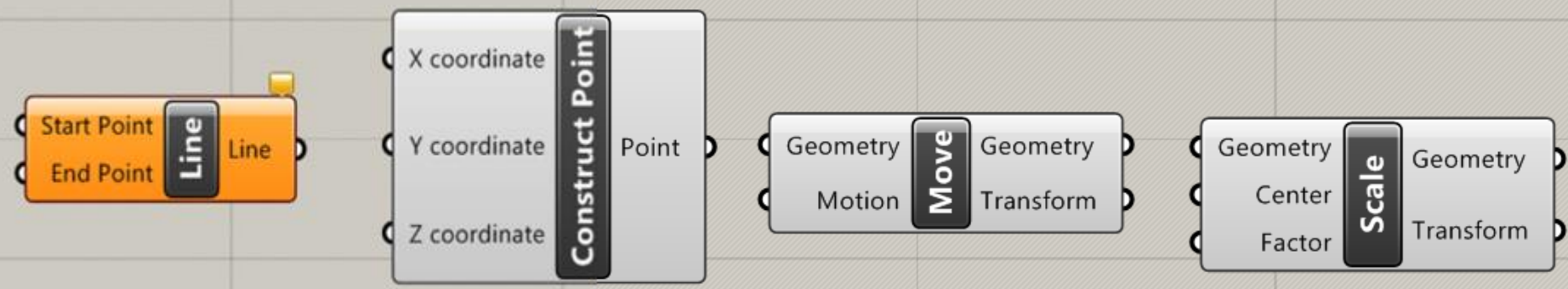

SCALE AND MOVE

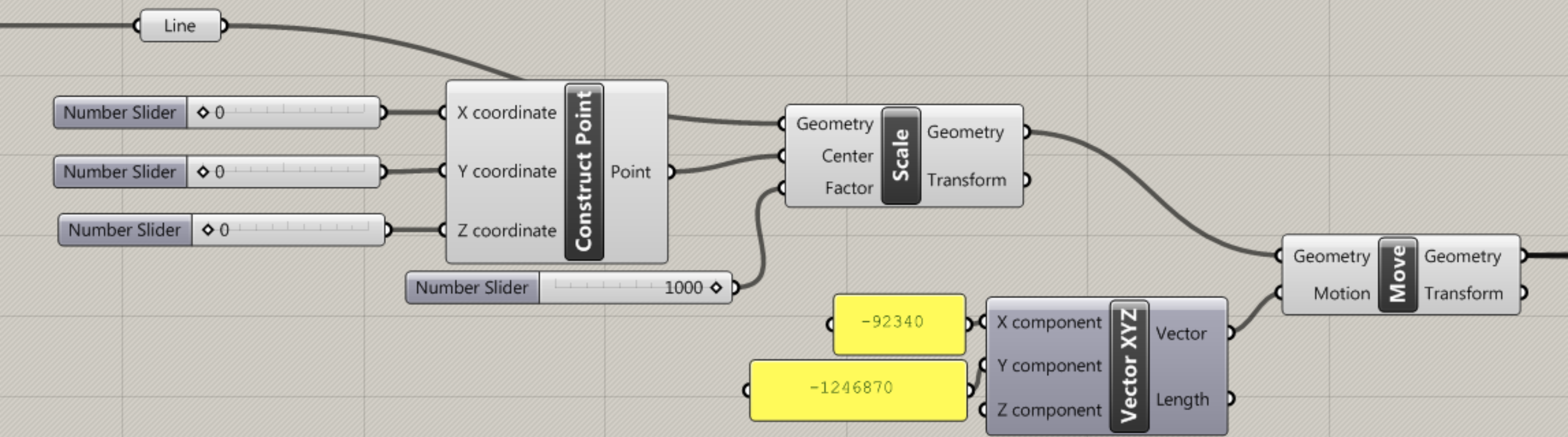

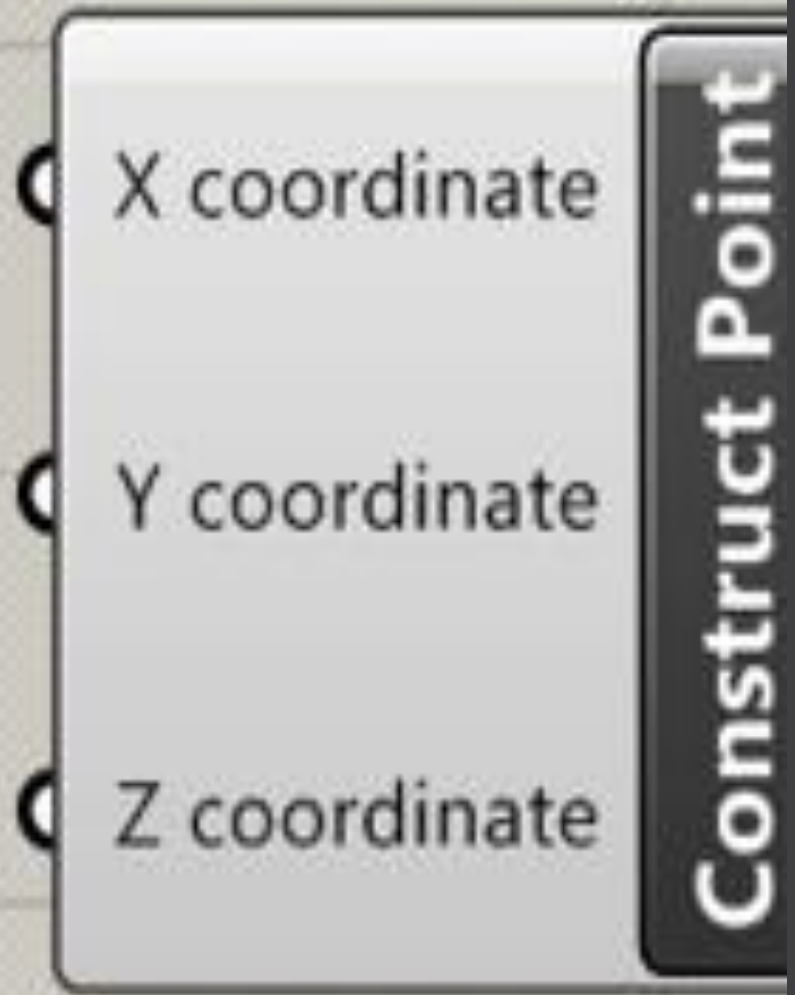

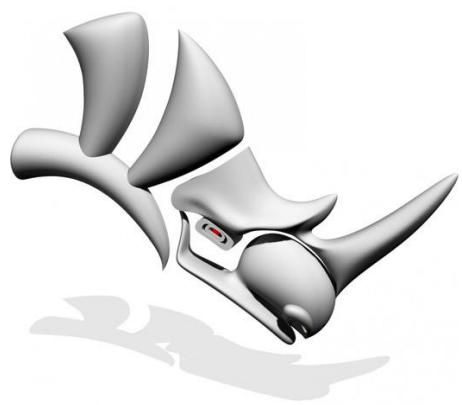

RhinoCeros[®]
NURBS modeling for Windows

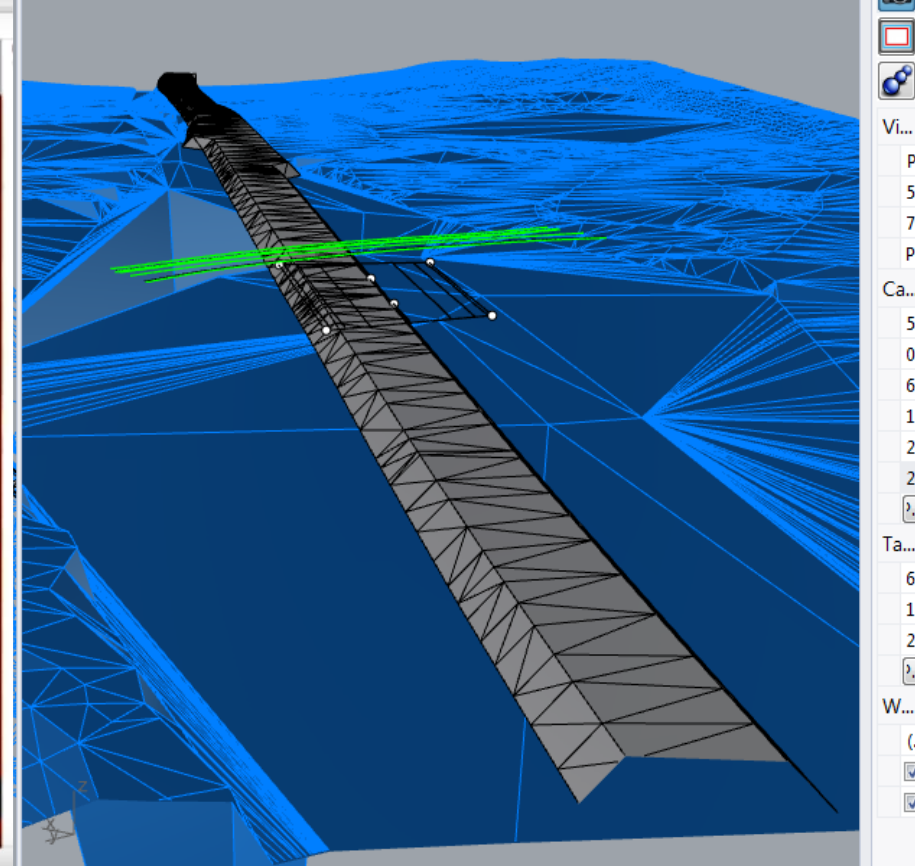
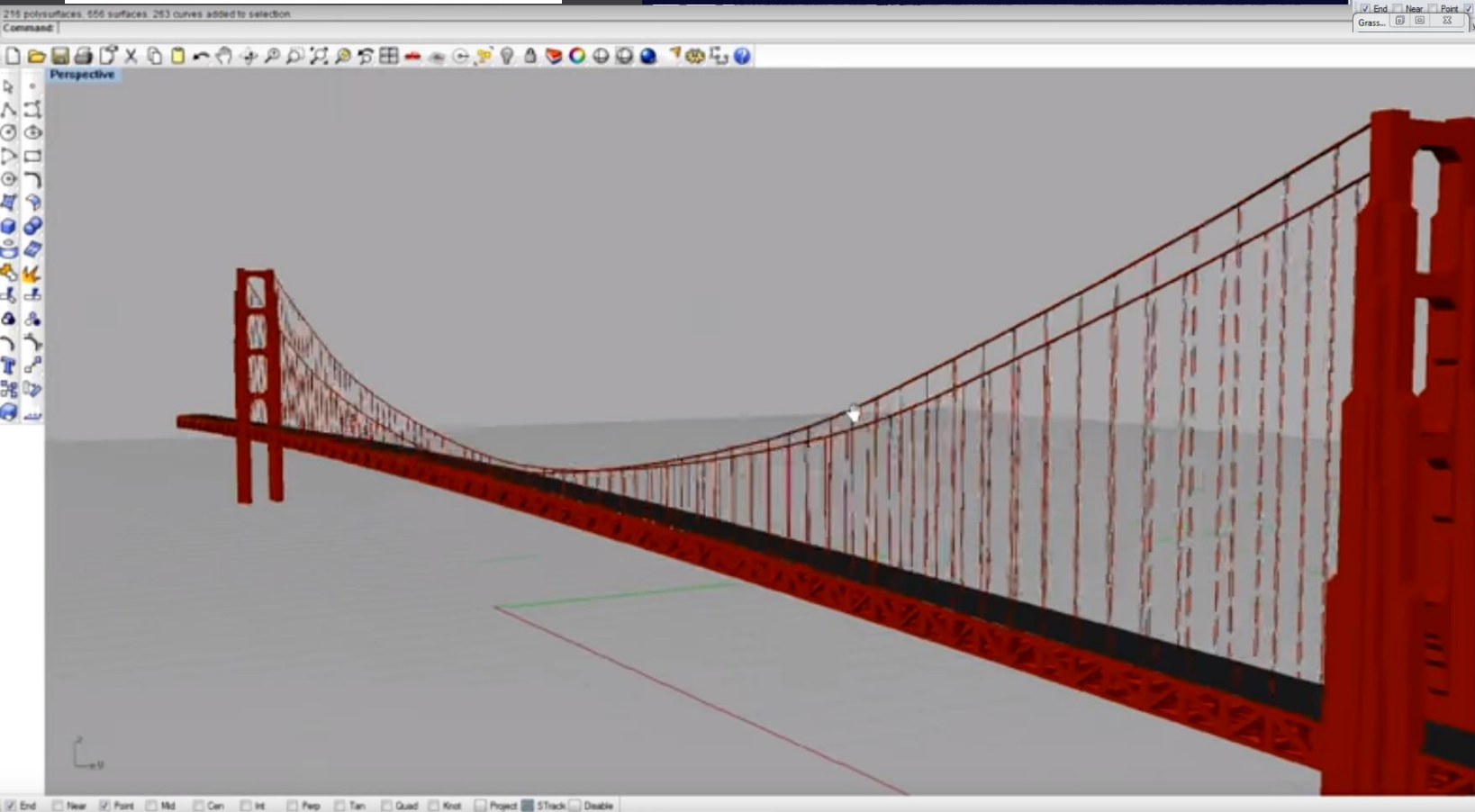
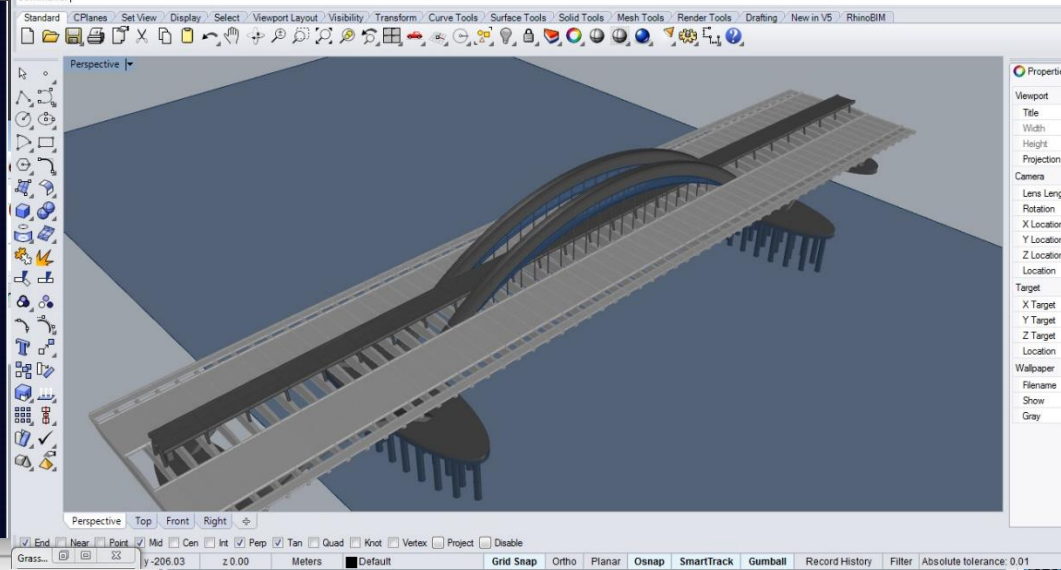
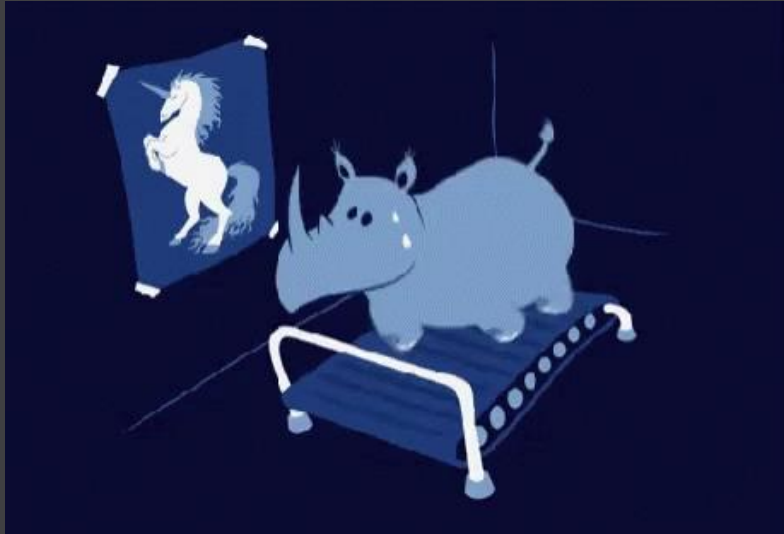



‘konseptuell design’

‘automatisering av oppgaver’

‘algorithmic design’



‘parametric design’



‘parametriske digitale’



‘generative design’

‘computational design’



‘designoptimalisering’



Parametric Design

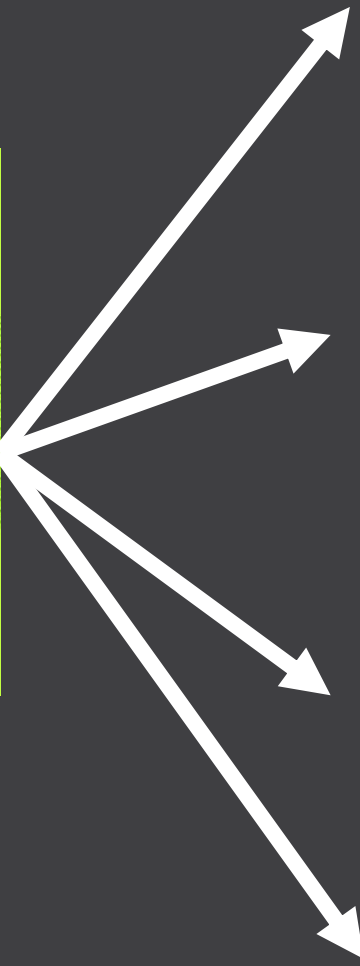



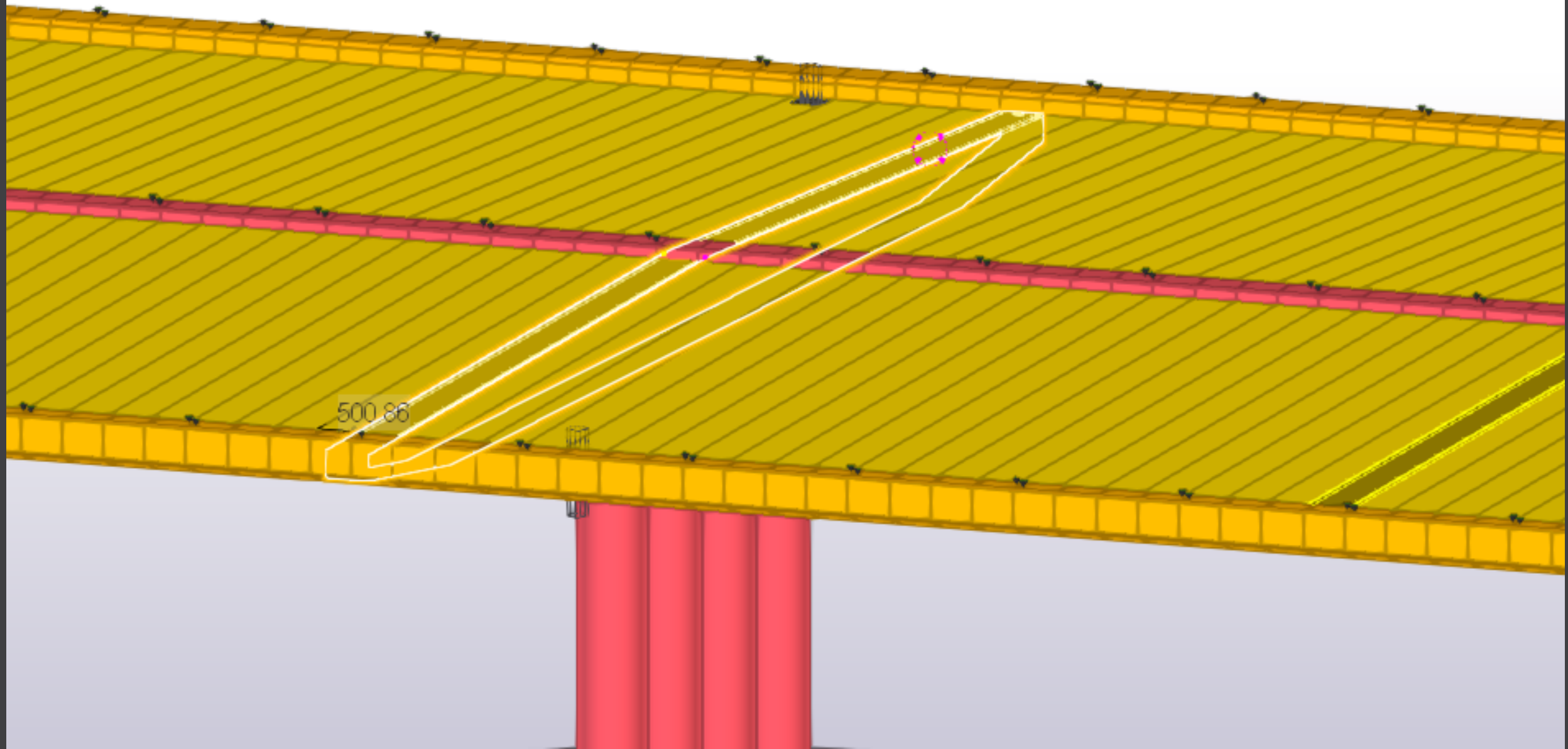

500 86

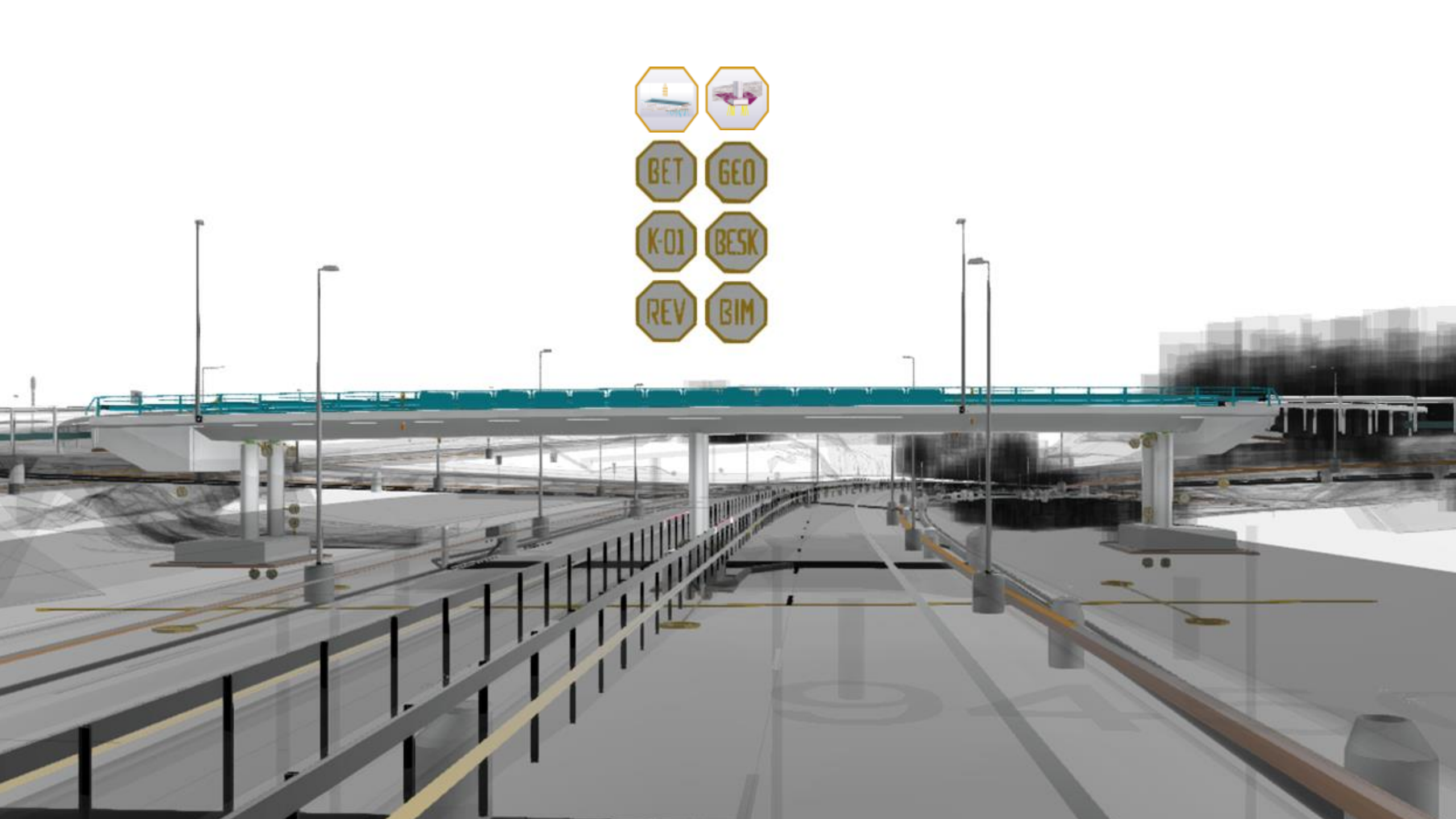

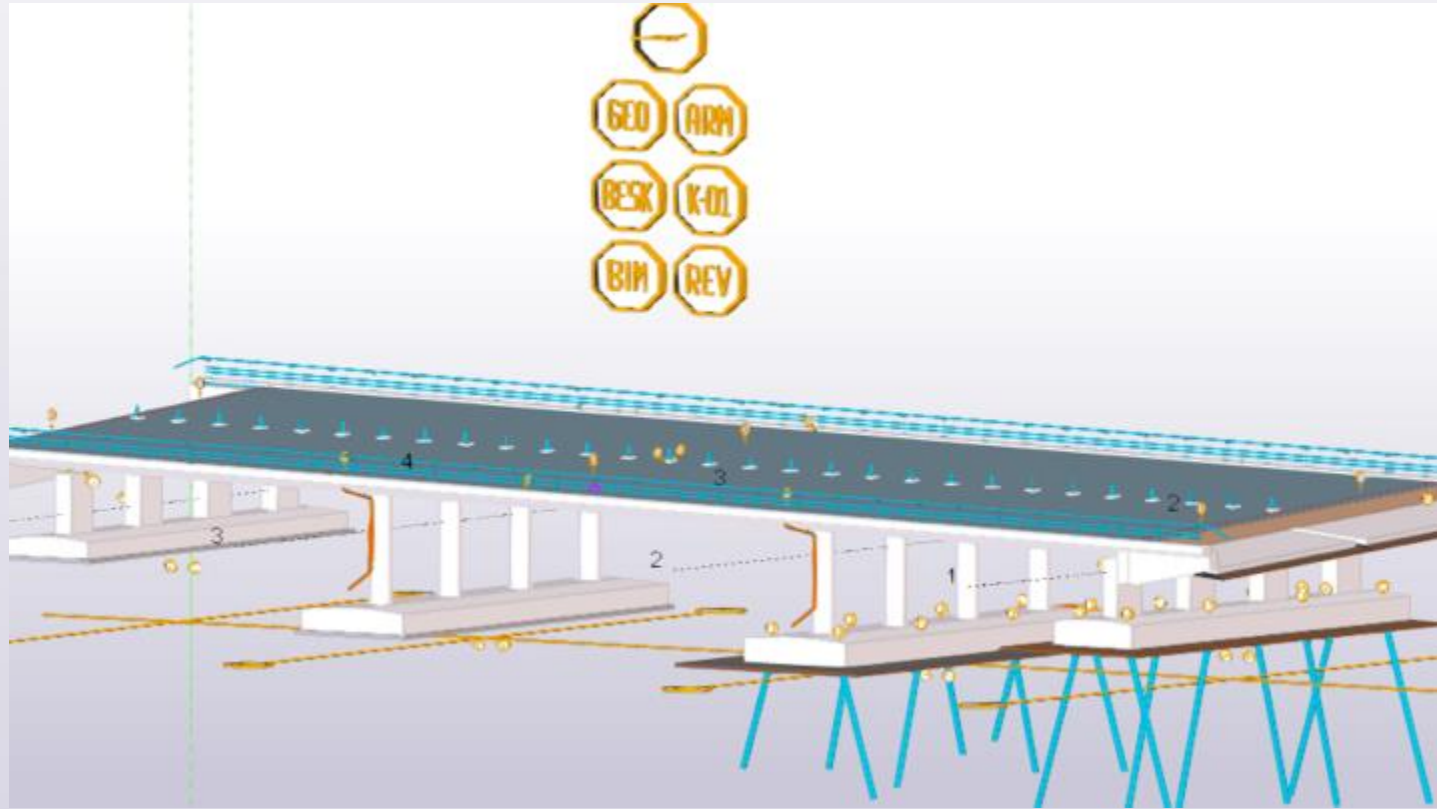

—

GEO	ARM
BESK	K-OL
BIM	REV

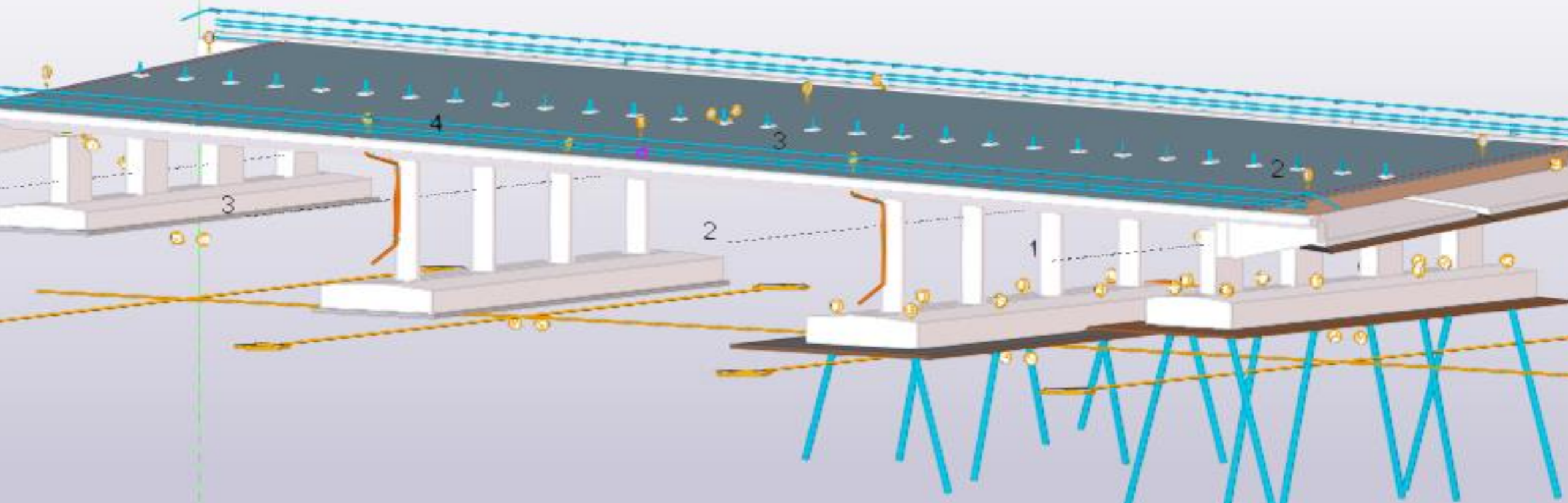

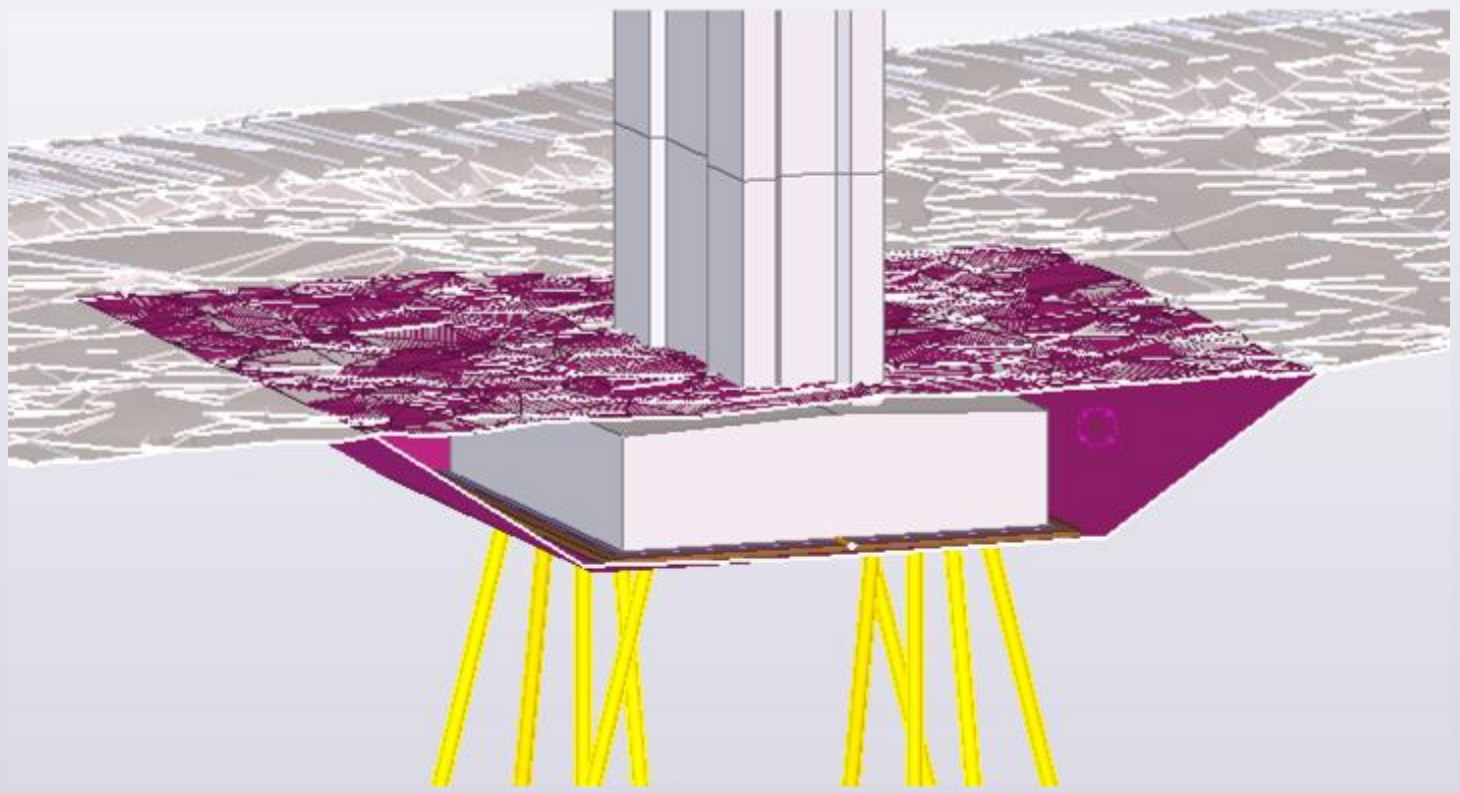

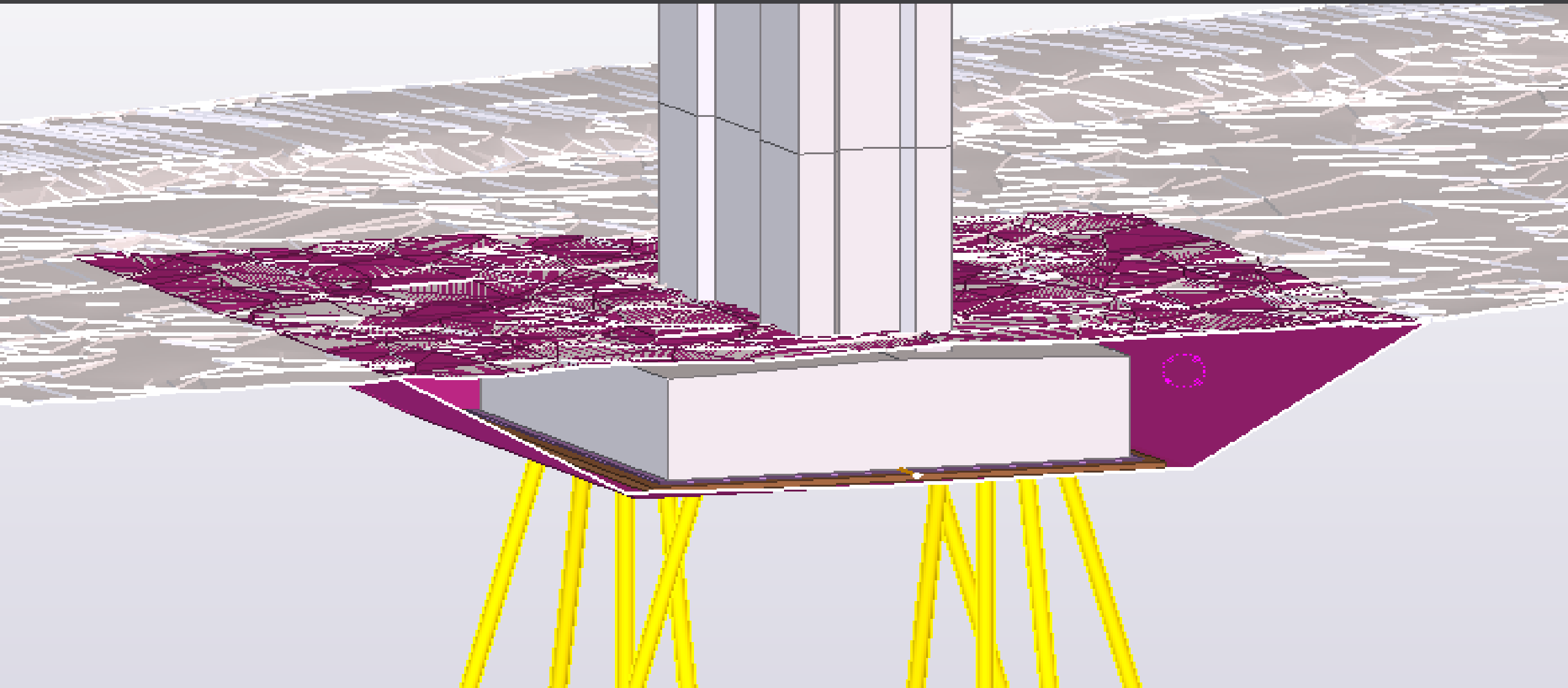

1. Ulik geometri
2. Trumpet formen
3. Tegningsløsprosjekt
4. Korte tidsfrister

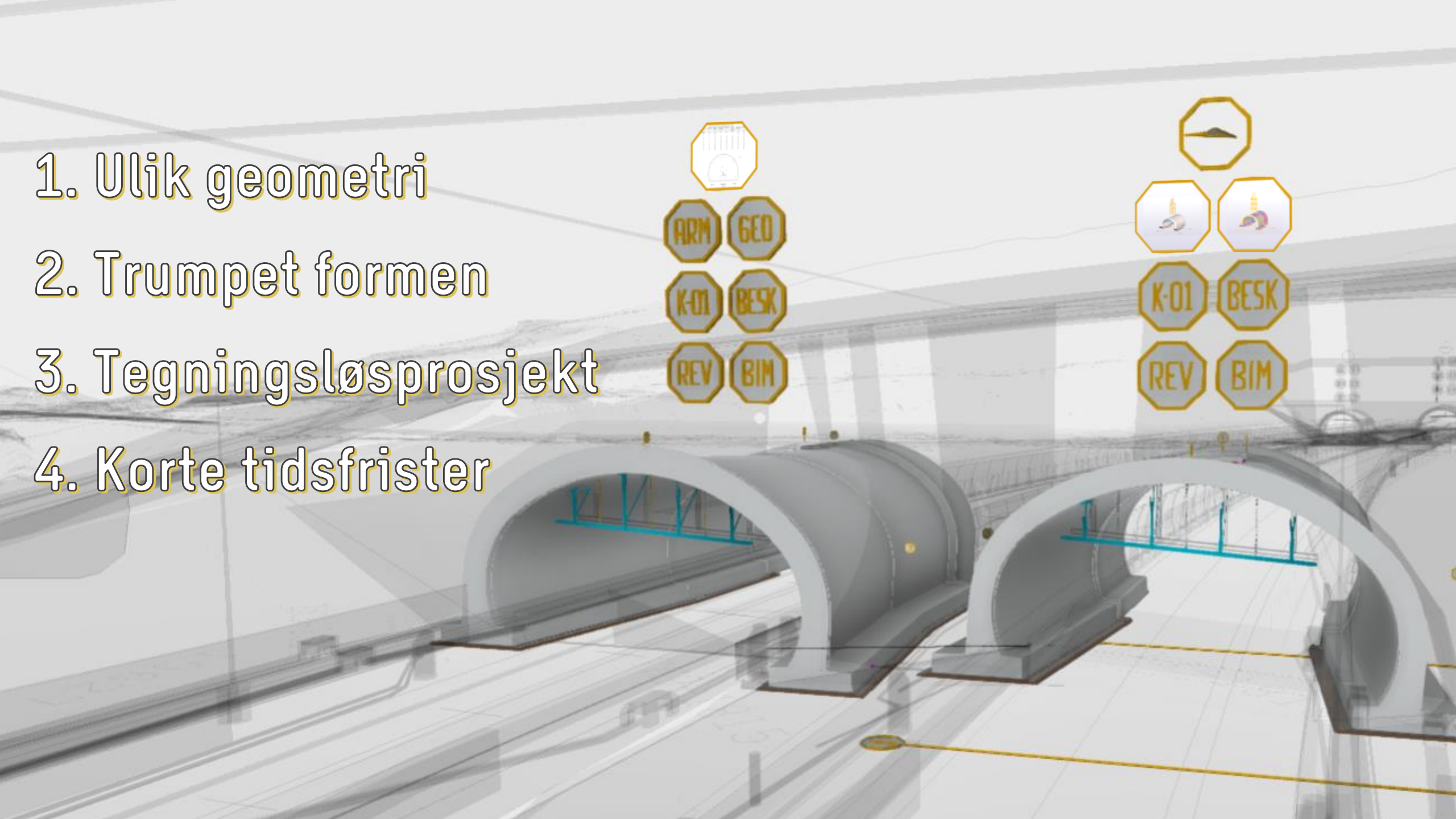



ARM

GEO

K-01

BESK

REV

BIM



K-01

BESK

REV

BIM

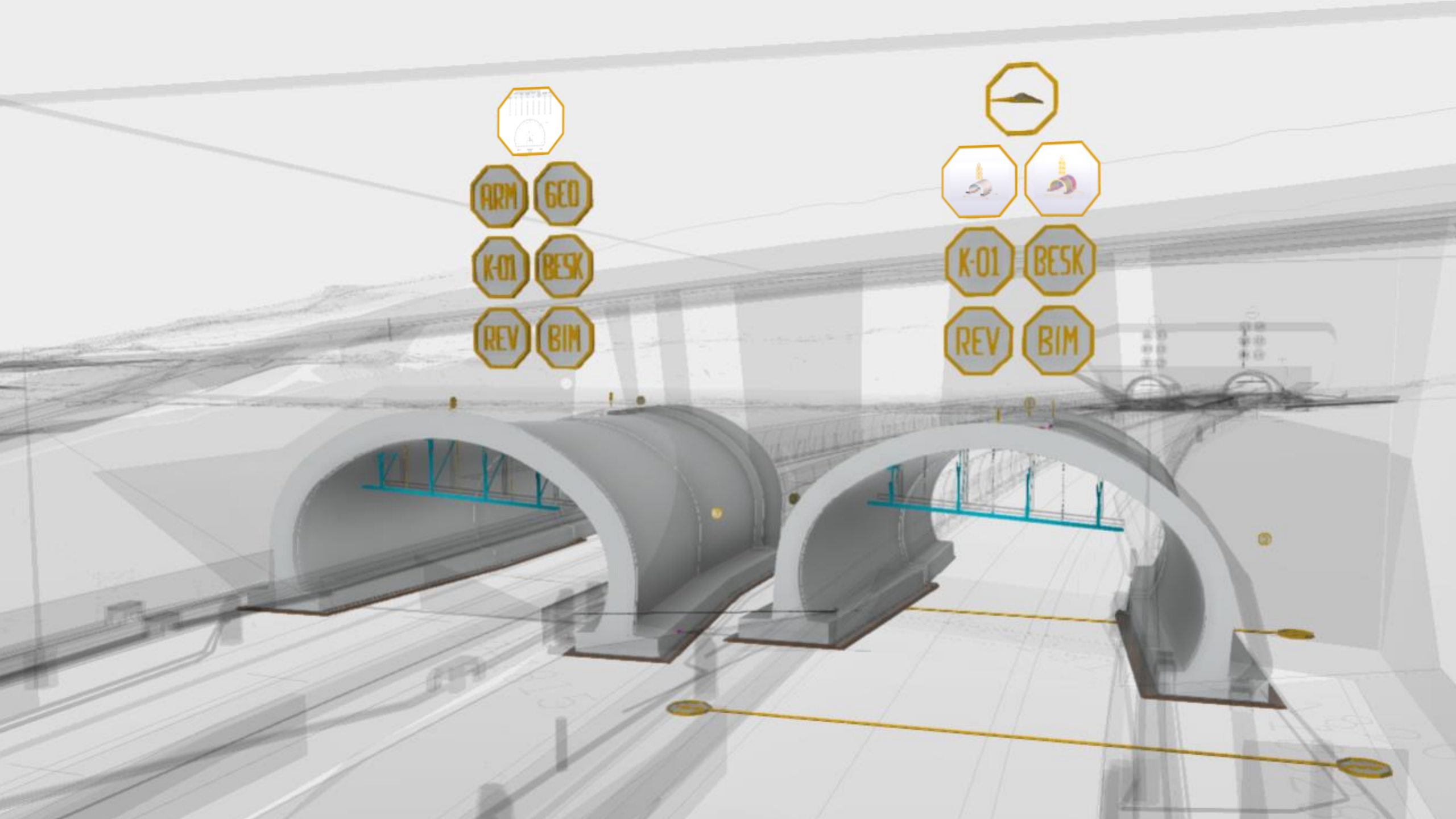

Geometriske mål for de ulike tunnelprofilene (alle mål gitt i m)

Profil	Total bredde Bt	Kjørebane- bredde Bk	Senterhøyde veggradier Yv	Veggradius Rv	Senter- avstand veggradier X	Senterhøyde hengradius Yh	Hengradius Rh
T4	4,0	3,00	–	–	–	1,330	2,400
T5,5	5,5	3,50	1,770	4,790	3,402	3,171	2,587
T8,5	8,5	6,50	1,770	4,790	0,402	1,981	4,500
T11,5	11,5	9,50	1,770	4,790	2,598	-0,258	7,199
T7,5	7,5	5,00	1,570	4,790	1,550	2,481	3,594
T9,5	9,5	7,00	1,570	4,790	0,450	1,213	5,212
T10,5	10,5	8,00	1,570	4,790	1,450	0,664	5,950
T12,5	12,5	10,00	1,570	4,790	3,450	-0,466	7,458
T13	13,0	10,50	1,570	4,790	3,950	-0,735	7,825
T13,5	13,5	11,00	1,570	4,790	4,450	-0,817	8,053
T14,0	14,0	11,50	1,570	4,790	4,950	-1,294	8,575

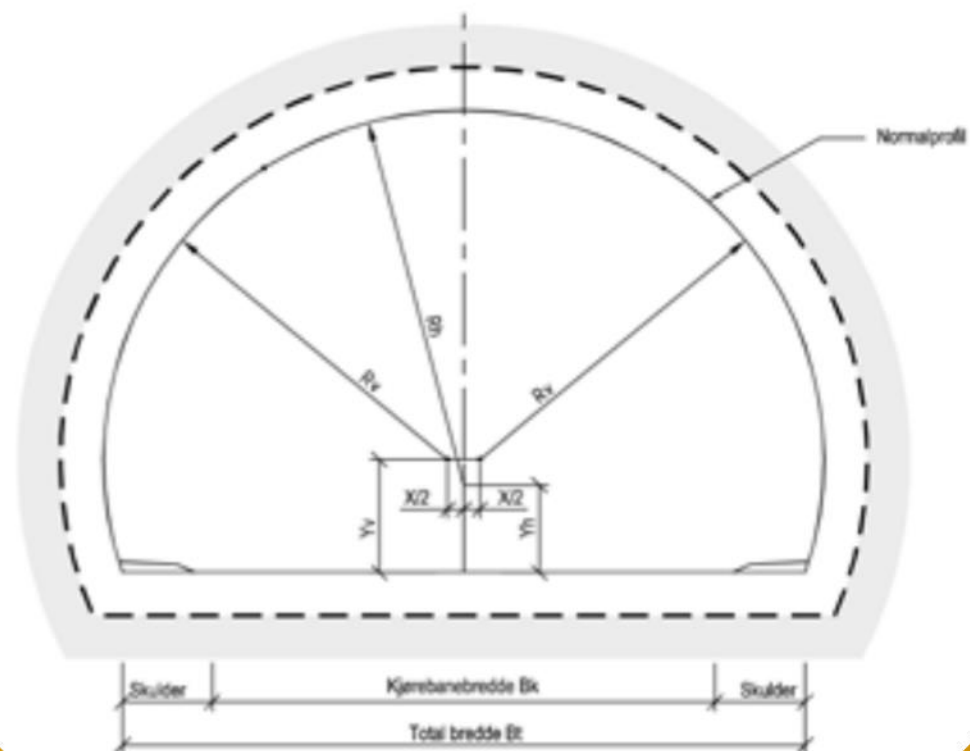

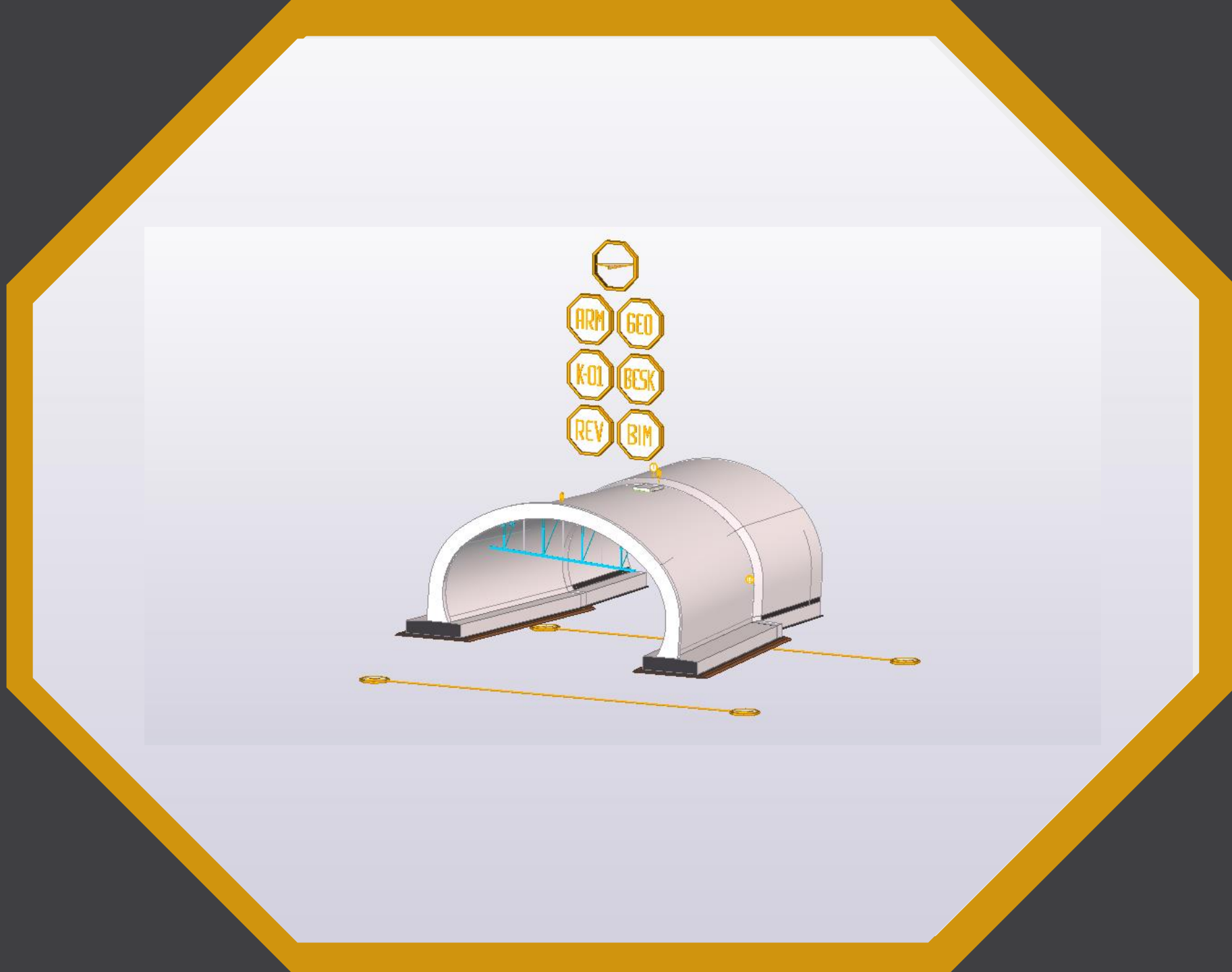

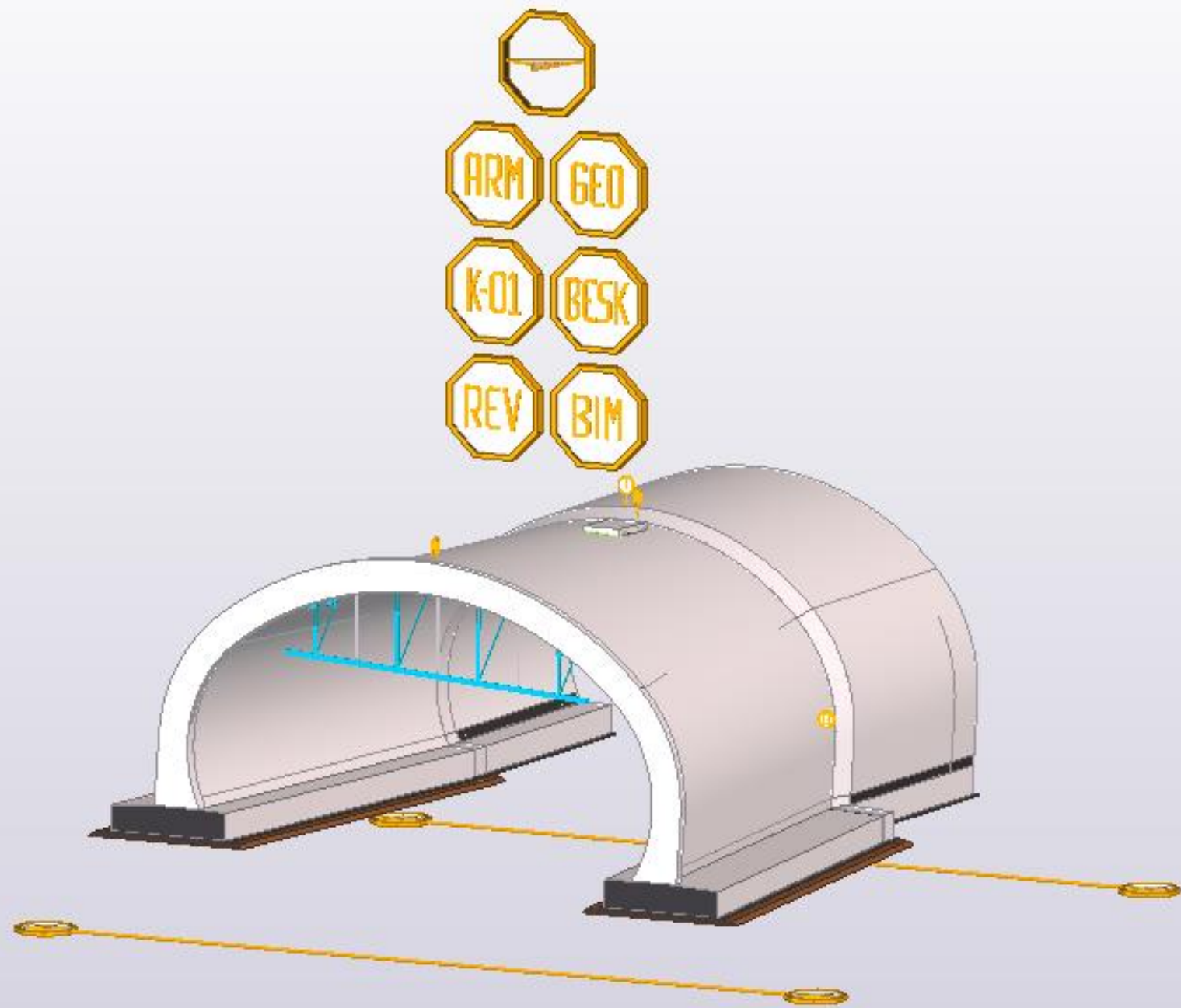

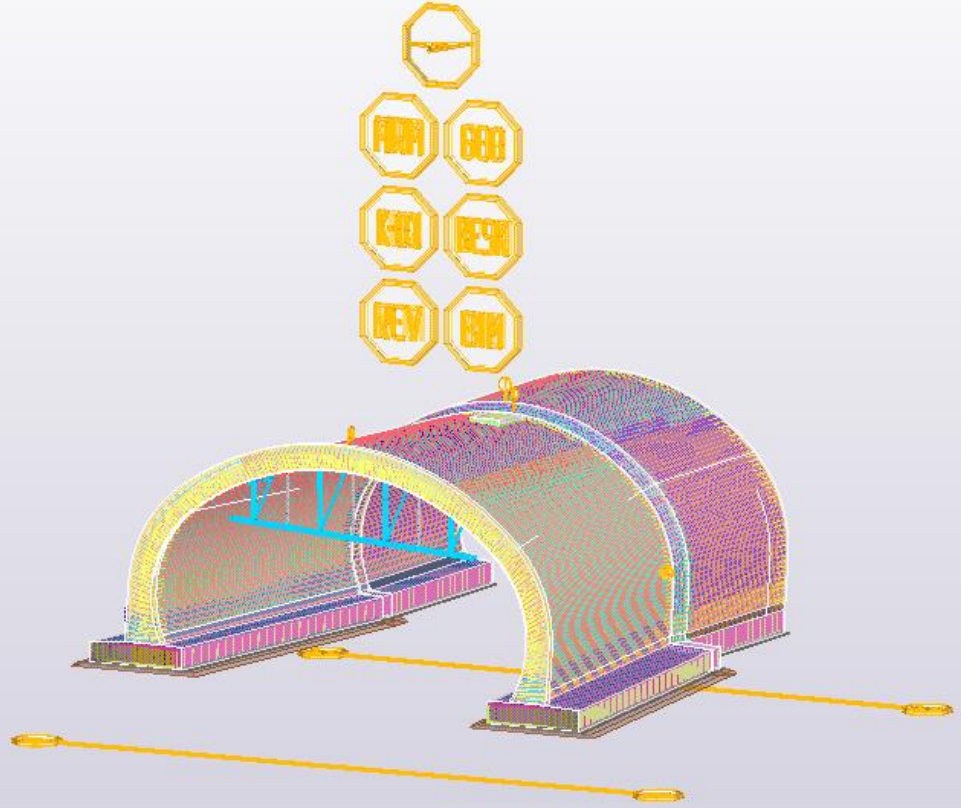

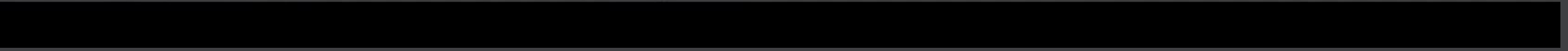
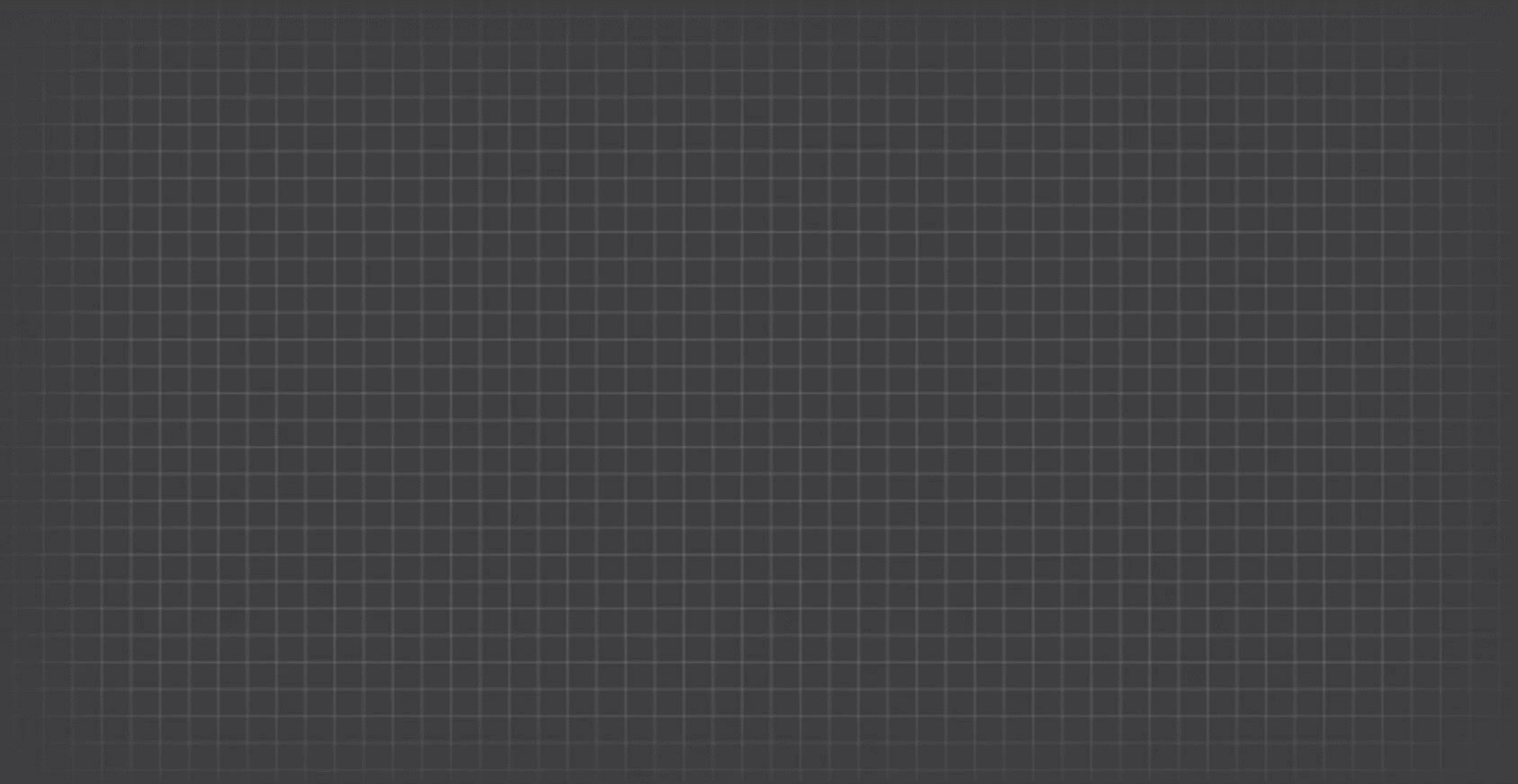
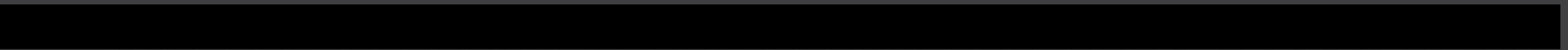

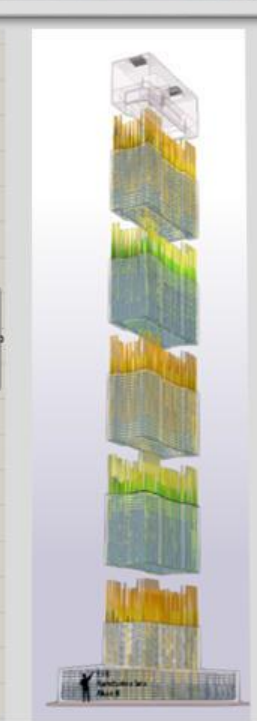
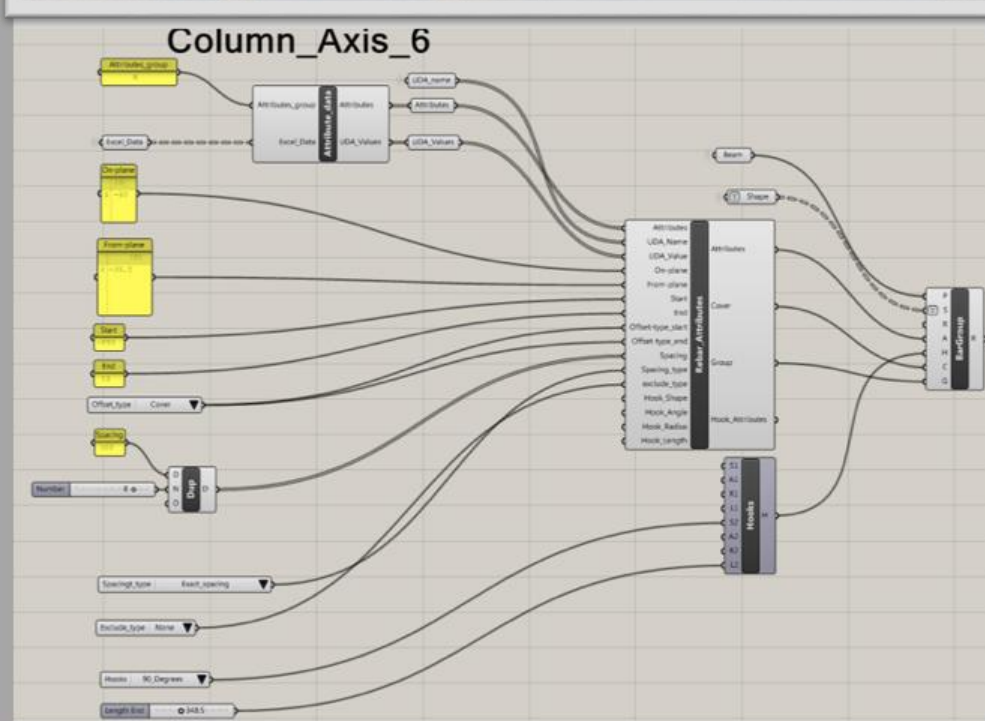
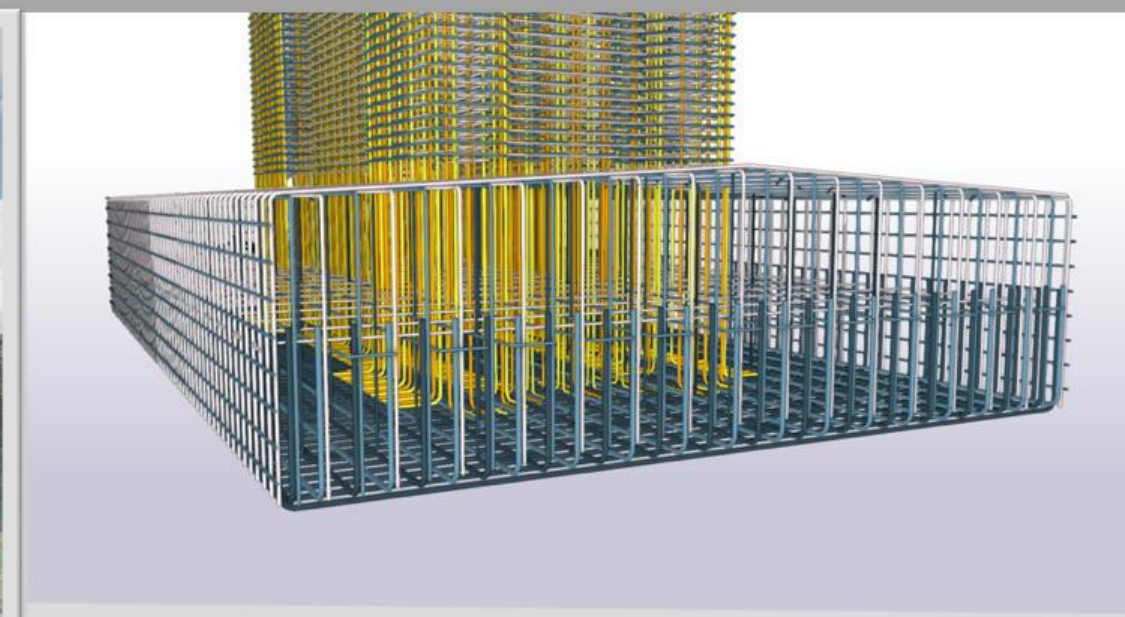

E16 RANDSELVA
HACKATON



2019-05-23











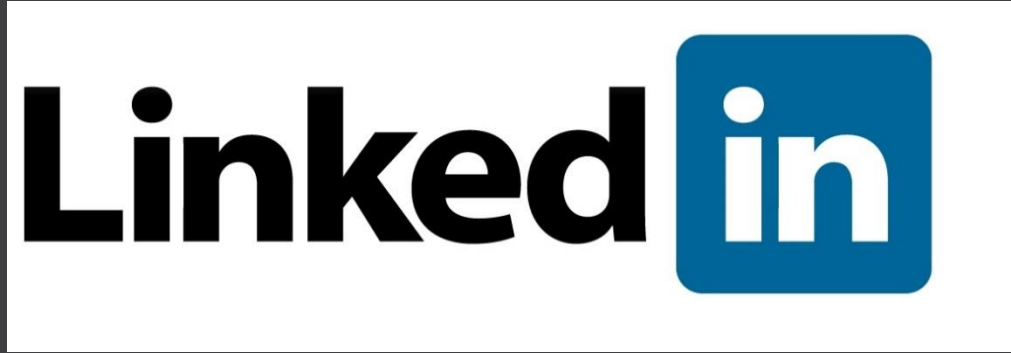

TAKK FOR MEG!

SPØRSMÅL ??

Krzysztof Wojslaw, Sweco Oslo Bru